

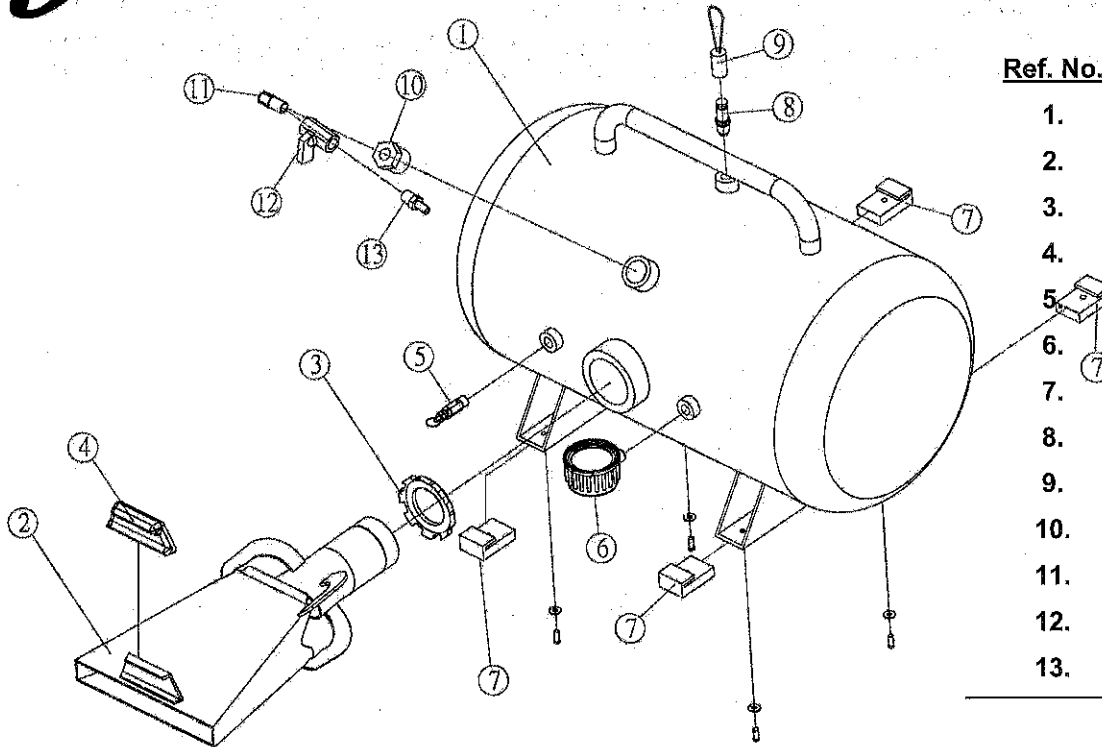

# Gaither Bead Booster® ( 2" GB-38L )

## Replacement Parts list



<u>Ref. No.</u>	<u>Part No.</u>	<u>Description</u>
1.	12910 BA	Aluminum Air Tank w/Piston Valve Inside
2.	12913 B2	2 Inch Jet Assisted Barrel
3.	12912 B2	( 50.8 mm ) 2" Lock Nut
4.	12927 B2	Wide Plastic Protector
5.	12917 B2	Safety Valve Max 8Bar
6.	12914	Pressure Gauge 10Bar
7.	12929 BA	Rubber Pads w/1 screw
8.	12919 B	Switch Valve
9.	12919 BS	Safety Trigger Caps
10.	12928 BA	3/4"PT x 1/4"PT Male Connector
11.	12915	90 Degree NPT
12.	12916BA	( 6.35 mm ) 1/4"PT Intake valve
13.	12927	( 6.35 mm ) 1/4"PT Universal connector

Gaither recommends this Bead Booster® tank be replaced after 3 years.

## **CAUTION** Aluminum

Maximum pressure 116 PSI. Recommended operating pressure 60-116 PSI. Overfilling may result in death or serious injury. Fill this tank only from a service station or similar low pressure- 116 PSI air compressor. Only replace filler valve, air hose, gauge with manufacturer recommended part or like fitting. Deflate tank before removing fitting. Discharge tank when not in use. Wear safety glasses and ear plugs. Do not remove or deface this label.

## Bead Booster Accessories

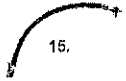
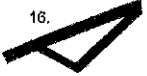
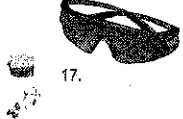
	14.	GB-51	KD-Tire Stand
	15.	GB-52	Air-Whip Hose
	16.	GB-53	Tire Wedge
	17.	GB-54	Safety Pack ( goggles & ear plugs )